



ResoDeck32 PRO

Product Information & Technical Data Sheet

Resonate's **ResoDeck32 PRO** is a high performance acoustic flooring solution and is laid as a floating floor on top of the timber or concrete sub-floor, before the final floor coverings (carpet, laminate etc) are installed.

The panels are 1200mm x 600mm, half the size of standard chipboard sheets. This makes them easier to deliver and to install on upper floors of any property.

Easy Install Soundproofing

The 32mm thick **ResoDeck32 PRO** panels have minimal impact on floor height. The 22mm P5 chipboard top layer is technically bonded to 10mm **ResoFleece**, a high performance fibre resilient layer.

The **ResoFleece** resilient layer provides superior impact sound reduction, making it ideal for residential properties that require excellent reduction of foot fall noise. The tongue and groove edge detail allows for fast and simple installation, perfectly suited for refurbishment applications.

Key Benefits



**Excellent
impact sound
reduction**



**Easy to install
1200 x 600 mm
board, tongue and
groove edge**



**Low profile
solution, low
impact on floor
height**



System Details

1. Resonate **ResoDeck** floor panel
2. **ResoEdge** flanking strip

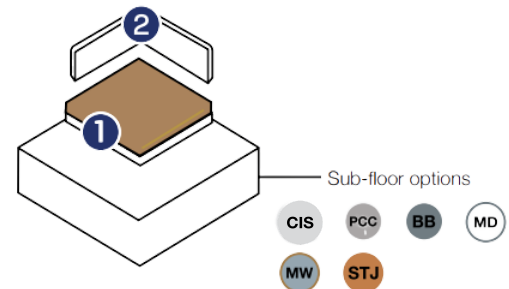

Dimensions

Panel Dimensions

600 mm (W)
1200 mm (L)
32 mm (H)

Panel Weight

16 kg/m²
11.5 kg Per Panel

Panels Per Pallet

70 Panels (50.4 m²)

Panel m²

0.72 m² Per Panel

Pallet Dimensions

1200 mm (W)
1200 mm (L)
1250 mm (H)

Pallet Weight

820 kg

Robust Detail Compliant

E-FC-1 (FFT 5)

E-FC-2 (FFT 5)

E-FS-1 (FFT 5)



Product Applications

Concrete In-situ Floor CIS

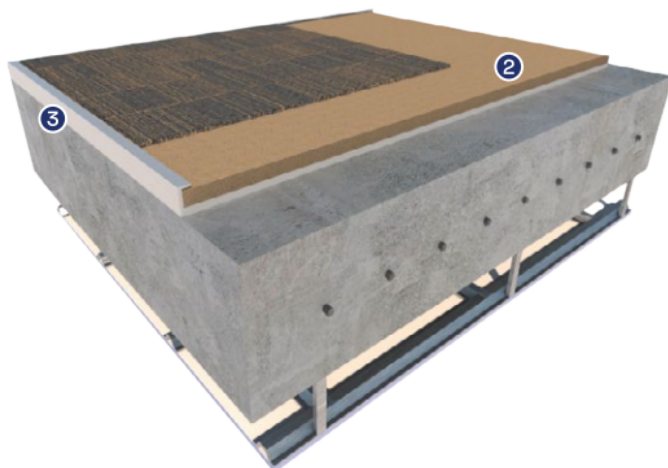

1. Carpet and underlay
2. Resonate **ResoDeck32 PRO**
3. **ResoEdge L30** flanking strip
4. 200mm Reinforced in-situ concrete slab
5. MF Ceiling (min 100mm void)
6. 1 x 9.5mm acoustic plasterboard

Airborne Sound Performance DnT,w + Ctr	51 dB
Impact Sound Performance LnT,W	49 dB
Impact Noise Improvement ΔLw	21 dB



Solid Timber Joisted Floor STJ

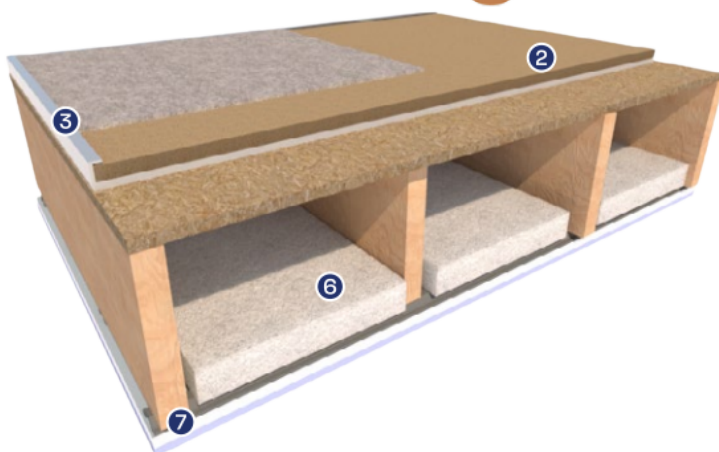

1. Carpet and underlay
2. Resonate **ResoDeck32 PRO**
3. **ResoEdge L30** flanking strip
4. 18mm (min) timber sub floor
5. 200 (min) timber floor joists
6. **Resoquilt** 50mm soundproofing wool
7. 16mm **ResoBar** resilient bars
8. 2 x 15mm acoustic plasterboard

Airborne Sound Performance DnT,w + Ctr	50 dB
Impact Sound Performance LnT,W	55 dB



Steel Joisted Floor SJ

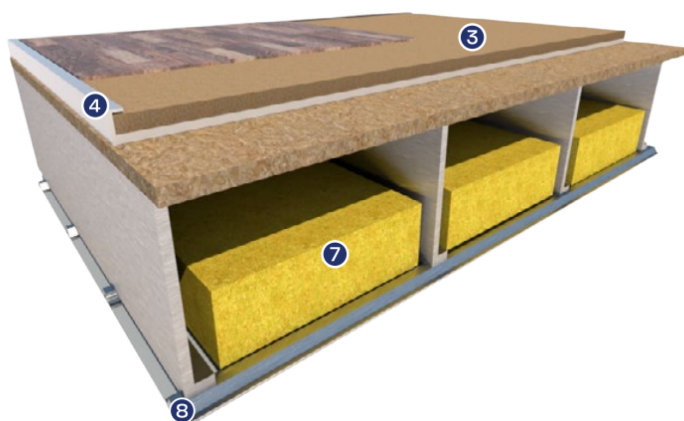

1. Engineered timber flooring
2. Self-levelling and adhesive layers
3. Resonate **ResoDeck32 PRO**
4. **ResoEdge L30** flanking strip
5. 18mm (min) timber sub floor
6. 225mm (min) steel floor joists
7. 100mm 45kg/m³ mineral wool
8. 16mm **ResoBar** resilient bars
9. 2 x 15mm acoustic plasterboard

Airborne Sound Performance DnT,w + Ctr	49 dB
Impact Sound Performance LnT,W	55 dB



Performance figures shown are for indicative purposes only. For technical advice specific to your project please contact Resonate Systems technical team.



Product Applications

Profiled Metal Deck Floor MD

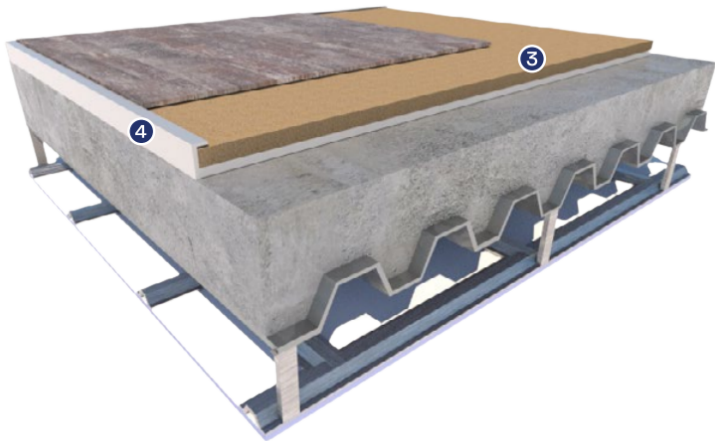

- 1. Laminate Flooring
- 2. Adhesive or decoupling layer
- 3. Resonate **ResoDeck32 PRO**
- 4. **ResoEdge L30** flanking strip
- 5. 130mm concrete on profiled metal deck
- 6. MF Ceiling (min 100mm void)
- 7. 1 x 9.5mm acoustic plasterboard

Airborne Sound Performance DnT,w + Ctr	51 dB
Impact Sound Performance LnT,W	dB

