

PRODUCT DATASHEET

RDAC 'Clip-on' Self-Levelling Adjustable Decking Pedestal for Aluminium Joists

RDAC clip-on self-levelling adjustable decking pedestal supports allow RynoDeck aluminium joists to be 'clicked' into place

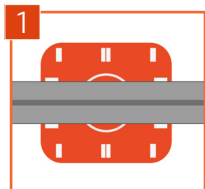

1 Single joists 'click' into place on the pedestal.

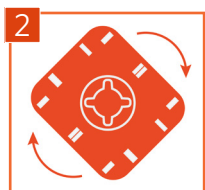

2 'Clip-on' head rotates through 90°

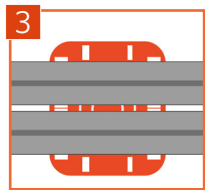

3 Double joists 'click' into place side by side, perfect for supporting board joints.

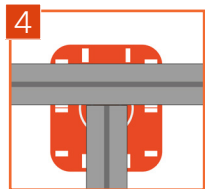

4 Versatile design allows for multi-directional applications.

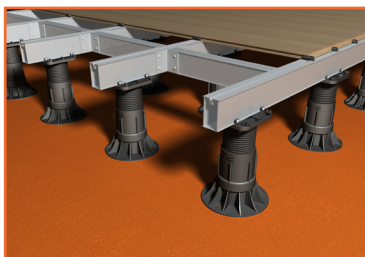

'CLIP-ON' SELF-LEVELLING HEAD

- Allows RynoDeck aluminium joist profiles to simply be 'clicked' into place
- Unique multi-directional head allows for single joists, double joists, and perpendicular profiles
- Incorporates self-levelling design to easily accommodate sloping areas of up to 10.5% (6°)

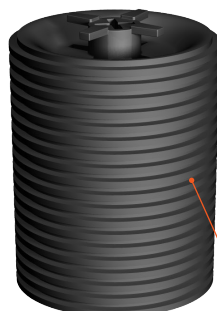
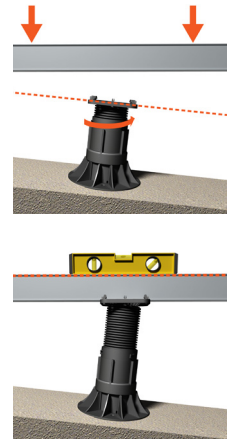

ADJUSTABLE THREADED SECTION

Easily allows millimetre perfect adjustment within given range.



HEIGHT EXTENSION COLLAR

- Easy to attach with single 'click' motion
- Build up pedestals in 100mm increments



WIDE SUPPORTING BASE

- Evenly spreads load
- Protects membranes
- Water drainage holes prevent moisture build up
- Holes enable pedestals to be fixed to surface if required

TECHNICAL SPECIFICATION

Material	PP Polypropylene (recyclable), UV resistant
Biological/chemical	Resistant to moulds, algae, alkali, bitumen
Height range	40-56mm, 50-70mm, 70-110mm, 110-160mm, 150-210mm, 200-300mm, 300-400mm, 400-500mm, 600-700mm, 700-800mm, 800-900mm, 900-1000mm
Compression	2100kg (certified compression data available on request)
Base diameter	210mm / 220mm
Head dimensions	115 x 130mm
Bearer capacity	Single or double aluminium joists
Working Temperature	-40°C to 120°C



Castlepoint
Castle Way
Ellon AB41 9RG

01358 726000
sales@rynogroup.co.uk
rynogroup.co.uk