

Before assembly

- We recommend that time is taken to read the instructions before starting assembly, then follow the easy step by step guide. The instruction sheet is only a guide to the assembly. Certain items may not be shown to scale.
- Check all components prior to assembly
- This product should be assembled by no less than two people.
- Drill pilot holes for screws to avoid splitting and cracking the timber.



Recommended tools for assembly

- Power Drill/Screwdriver
- Cross-head drill bit
- 3mm diameter drill bit
- 6mm diameter drill bit
- 12mm diameter drill bit
- Hammer
- Sharp knife
- Spirit level
- Step ladder

Biocidal Products Regulation EU 528/2012

Wolmanit® CX treated wood, is a treated article incorporating biocidal products: copper hydroxide carbonate, bis(N-cyclohexyl-diazonium-dioxy)-copper and Boric Acid. They protect wood against fungal decay, rot and insect attack. Wear gloves when handling freshly treated wood. Avoid breathing dust when cutting wood. Dispose of off-cuts responsibly.

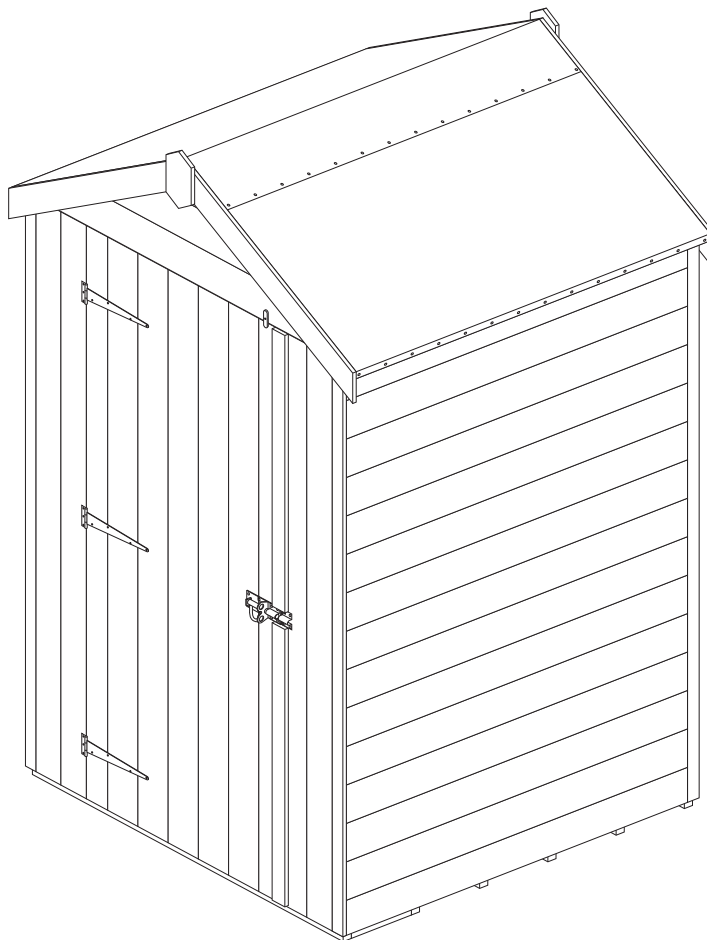

No.	Components	Qty.
1	Floor	1
2	Large wall panel (width 1174mm)	3
3	Small wall panel (width 190mm)	2
4	Apex panel	2
5	Door header rail (28x28x740mm)	1
6	Roof panel	2
7	Felt batten (28x28x1224mm)	2
8	Roof purlin (28x28x1200mm)	2
9	Roof felt roll (1.3m)	2
10	Door rebate strips (12x22x1685mm)	2
11	Corner coverstrips (12x40x1715mm)	4
12	Door	1
13	Door weather strip (12x48x830mm)	2
14	Bargeboard	4
15	Finial	2

No.	Fixing Kit	Qty.
16	T-Hinge	3
17	Pad bolt	1
18	Turn button	1
19	50mm coach bolt	4
20	Nut	4
21	Washer	4
22	60mm screws	10
23	50mm screws	23
24	32mm screws	20
25	25mm screws	28
26	20mm screws	6
27	30mm nails	48
28	10mm felt nails	56

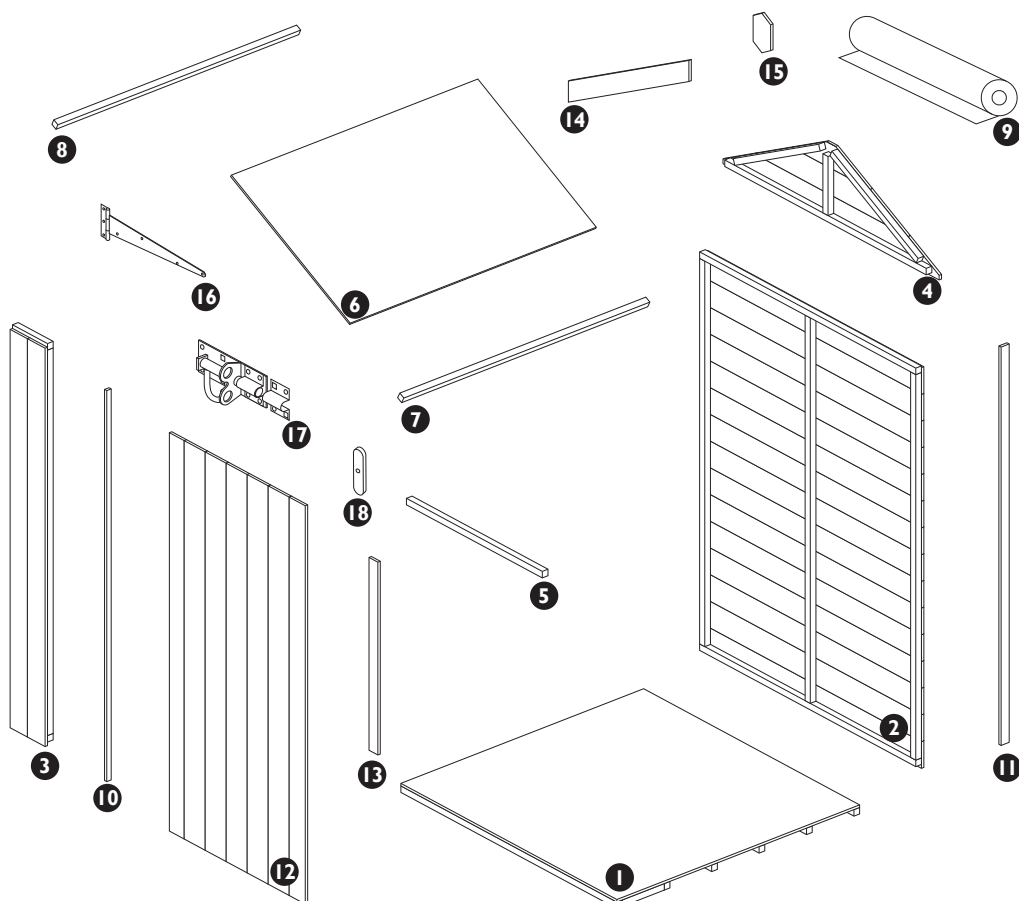

1. Floor

No.	Components for this section	Qty.
1	Floor	1

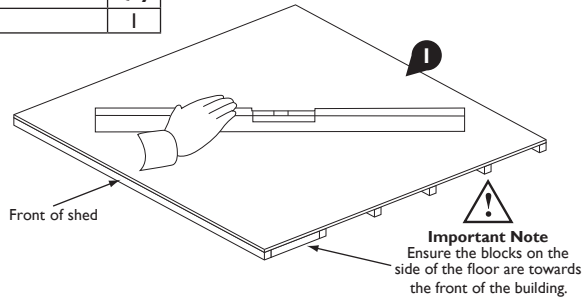

Prepare a firm level area that is slightly larger than the floor, for the shed to sit. To protect the floor and validate the anti-rot guarantee, adequate provision must be made to ensure ground contact is avoided. The building must not be allowed to sit in pooled water during wet conditions and air must be able to circulate underneath the building. Recommended base options include either:

- Concrete pad
- Slabs
- Decking
- 50x50mm pressure treated timber bearers (minimum requirement)

2. Wall Panels

No.	Components for this section	Qty.
1	Floor	1
2	Large wall panel (width 1174mm)	3
3	Small wall panel (width 190mm)	2

No.	Fixings for this section	Qty.
23	50mm screws	12

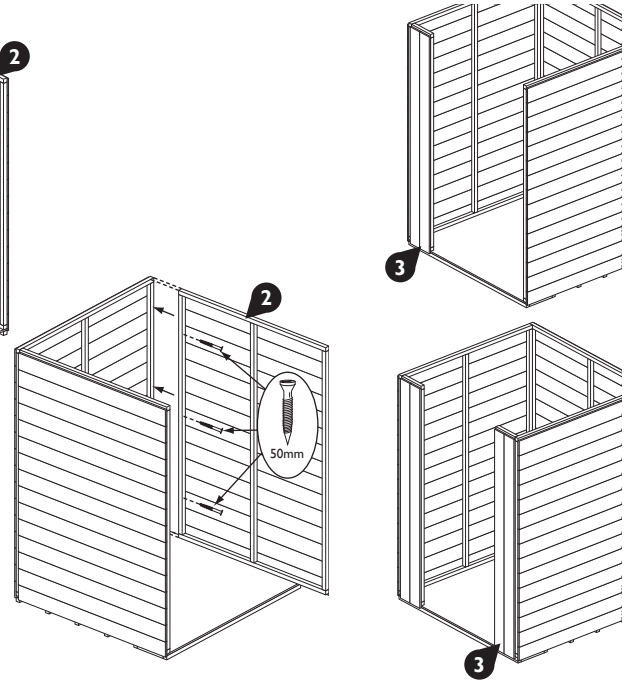
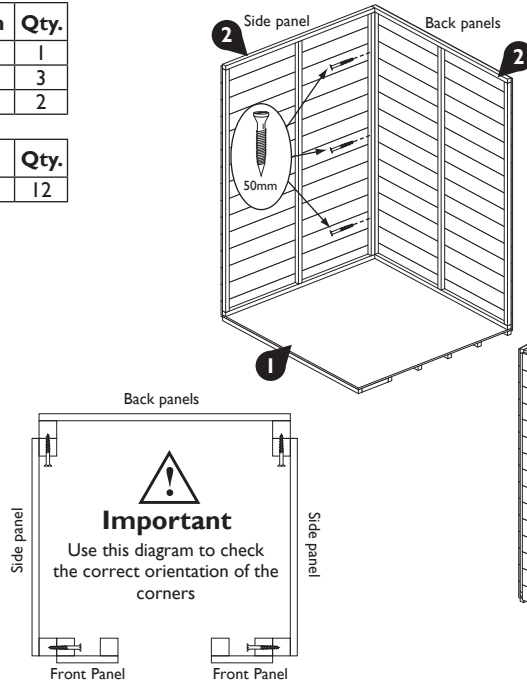
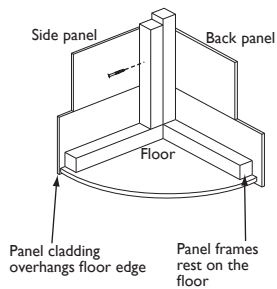

3. Apex Panels & Door Header Rail

No.	Components for this section	Qty.
4	Apex panel	2
5	Door header rail (28x28x740mm)	1

No.	Fixings for this section	Qty.
23	50mm screws	7

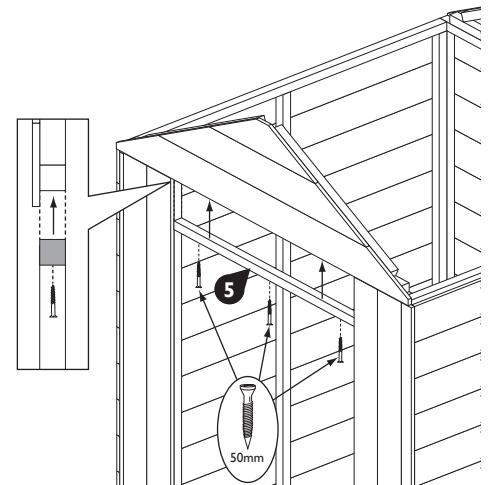
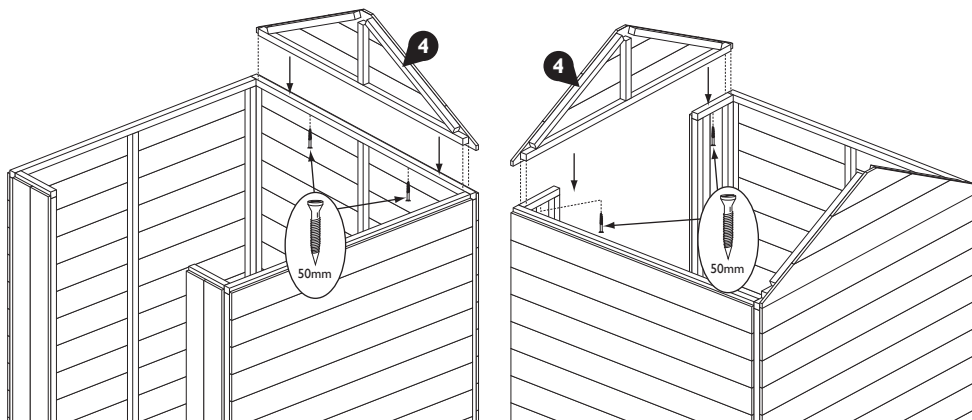

4. Secure Walls to Floor

No.	Fixings for this section	Qty.
22	60mm screws	10



Important Note

When screwing the walls to the floor. Always ensure the screws are aligned so that the screw goes through the wall panel frame and floor and into the floor frame.

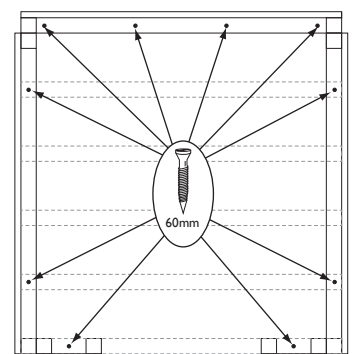
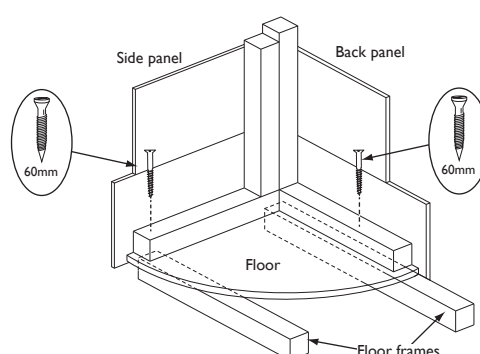

5. Roof Panels & Felt Battens

No.	Components for this section	Qty.
6	Roof	2
7	Felt batten (28x28x1224mm)	2
8	Roof purlin (28x28x1200mm)	2

No.	Fixings for this section	Qty.
23	50mm screws	4
24	32mm screws	20
27	30mm nails	12

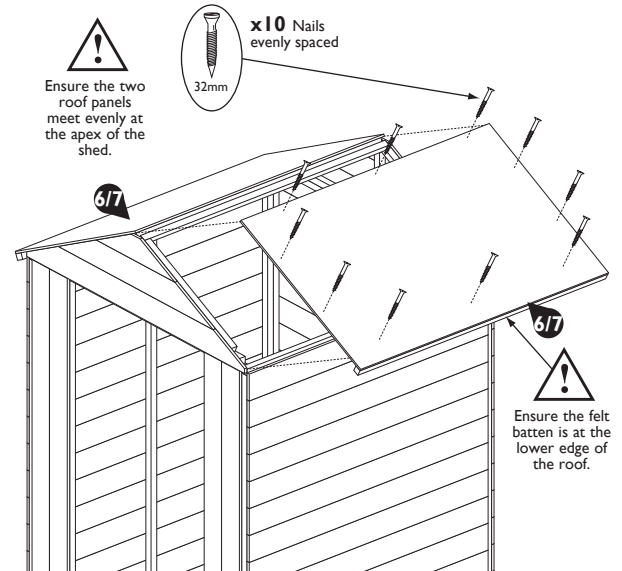
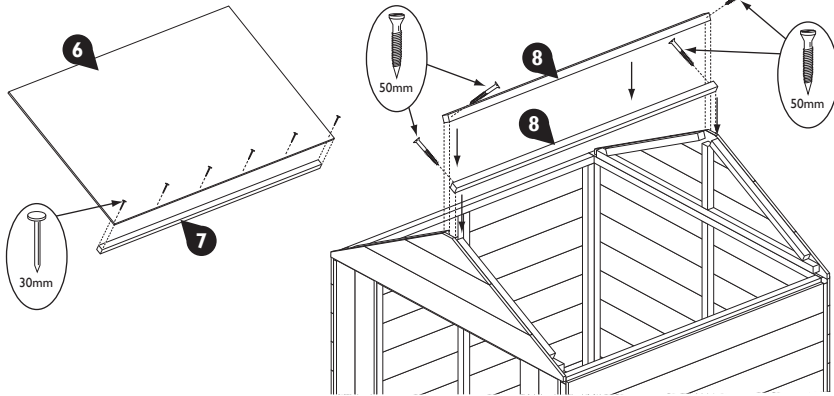

6. Roof Felt

No.	Components for this section	Qty.
9	Roof felt roll (1.3m)	2

No.	Fixings for this section	Qty.
28	10mm felt nails	56

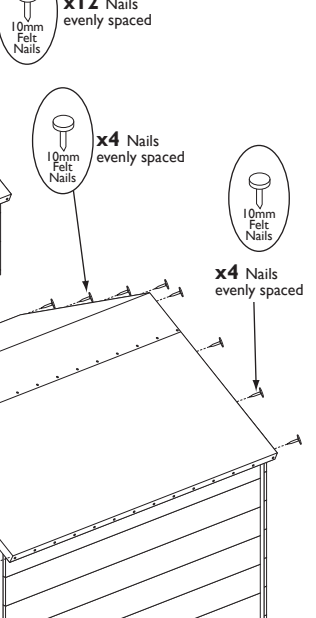
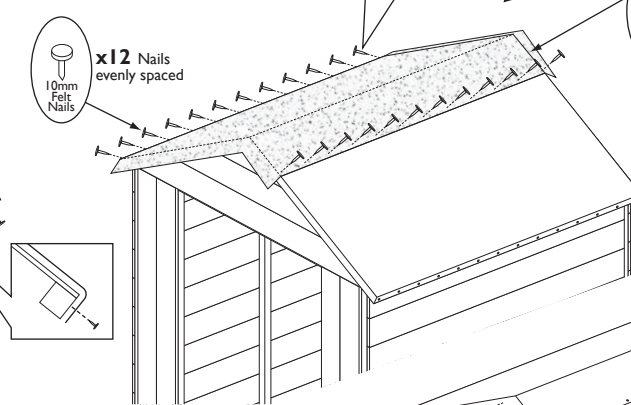
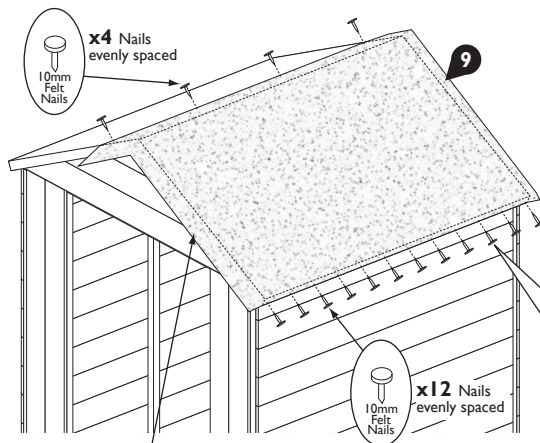

7. Door Rebate Strips & Corner Coverstrips

No.	Components for this section	Qty.
10	Door rebate strip (12x22x1685mm)	2
11	Corner coverstrip (12x75x1715mm)	4

No.	Fixings for this section	Qty.
27	30mm nails	20

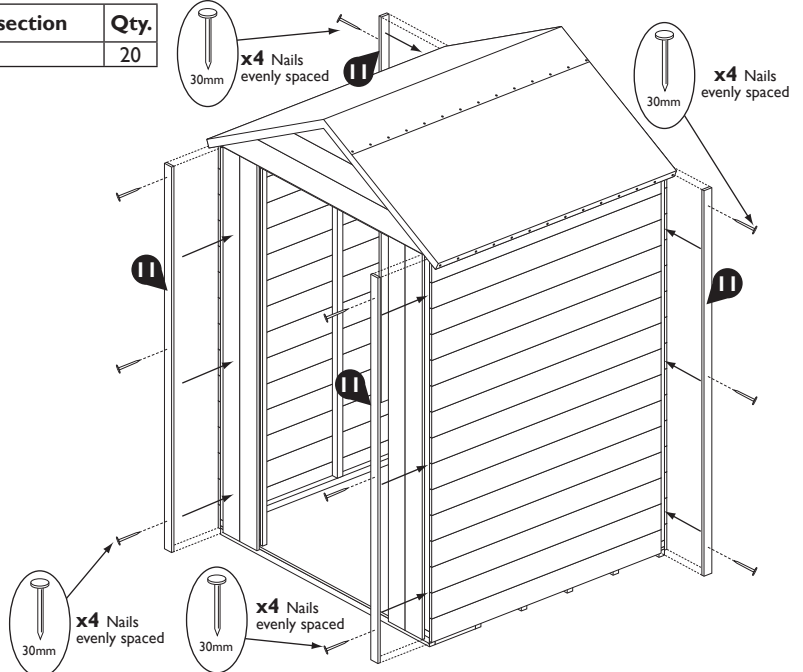
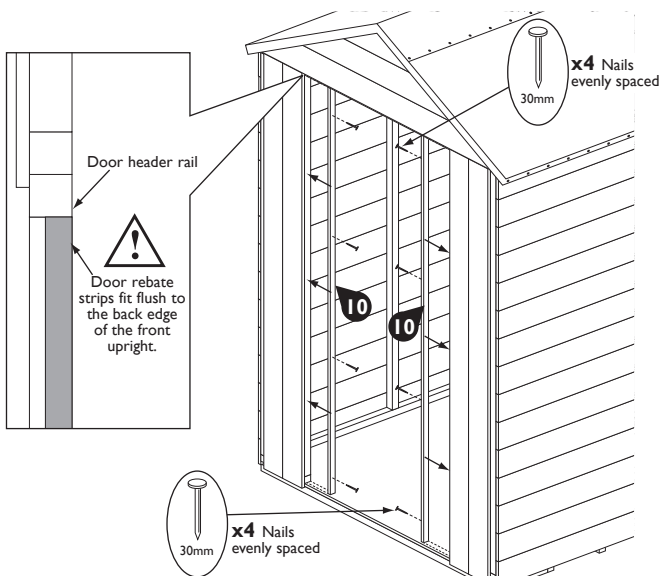

8. Door

No.	Components for this section	Qty.
12	Door	1
13	Door weather strip (12x48x830mm)	2

No.	Fixings for this section	Qty.
16	T-Hinge	3
17	Pad bolt	1
18	Turn button	1
19	50mm coach bolt	4
20	Nut	4
21	Washer	4
25	25mm screws	28
26	20mm screws	6

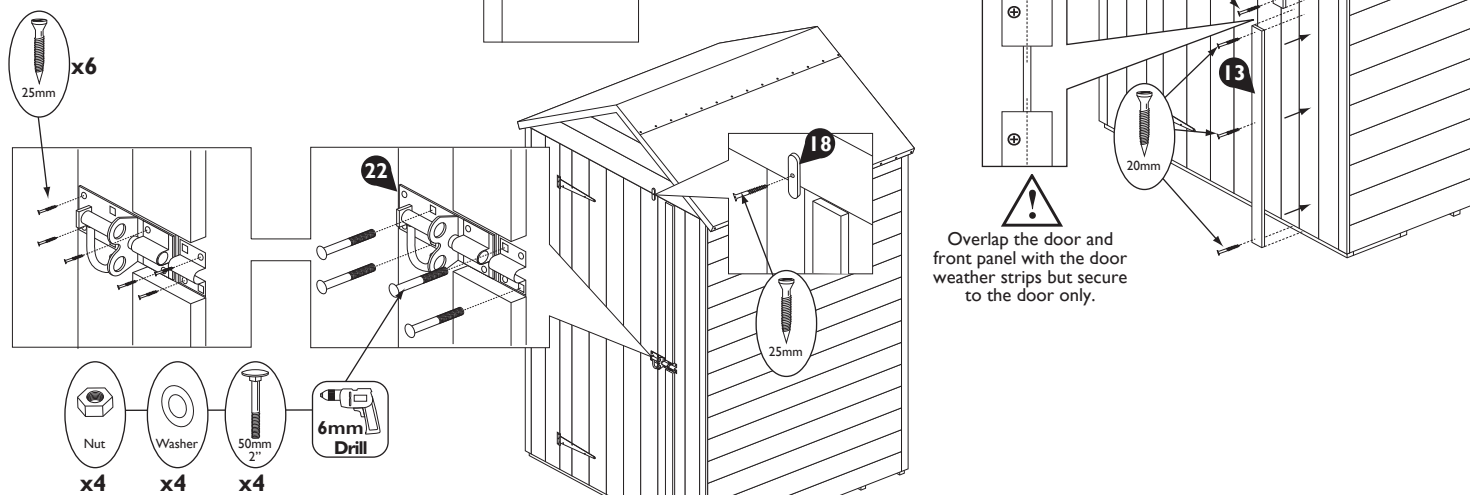

9. Bargeboards & Finials

No.	Components for this section	Qty.
14	Bargeboard	4
15	Finial	2

No.	Fixings for this section	Qty.
27	30mm nails	16

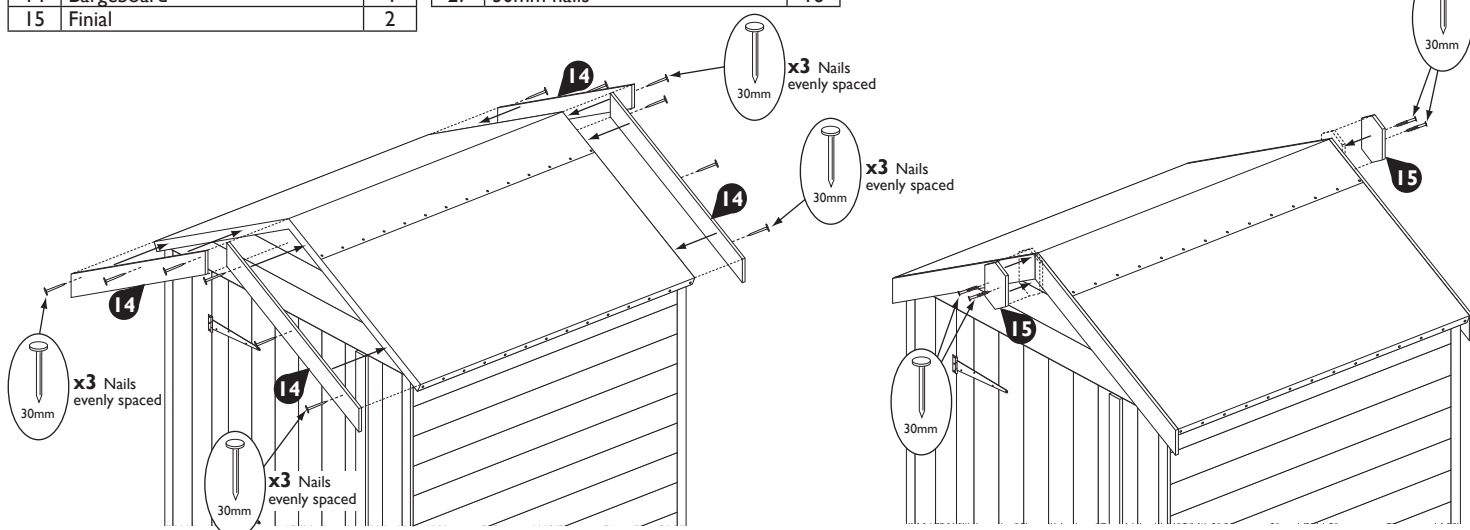

Important information - retain for future reference

Please dispose of all packaging responsibly and recycle where possible in line with local authority requirements.

Pressure treated buildings require no further preservative treatment, However they can be painted or stained if required.

Timber Information.

As timber is a natural material, there are certain weather conditions that may affect the materials properties. In times of excessive dry spells the material may lose some of its internal moisture causing a certain degree of shrinkage on a panel and in periods of excessive rain there will be a certain amount of swelling throughout the wooden panels. This process can not be avoided. If you have problems with certain boards shrinking in dry spells try to decrease the amount of direct sunlight on the building or the amount of air passing over the building.

If in doubt of any aspect regarding the assembly, use or safety of your building please contact us:

Help Line: (Normal Office Hours) 01829 261 121

Email: support@rowgar.co.uk

ROWLINSON GARDEN PRODUCTS LIMITED
Green Lane
Wardle Nr. Nantwich
Cheshire
CW5 6BN
www.rowgar.co.uk

We constantly improve the quality of our products, occasionally the components may differ from the components shown and are only correct at time of printing. We reserve the right to change the specification of our products without prior notice.

2024 © Rowlinson Garden Products Ltd