

**BUCKLEYS**

MANUFACTURERS OF SPECIALIST TEST EQUIPMENT

# Dry Roof Pro'



locate roof leaks in dry weather conditions



# Dry Roof Pro'

Our flat roof test kits enable inspectors to quickly and effectively test non-conductive roof finishes (such as bitumen, liquid-applied, single-ply and asphalt) for pinholes, porosity and other defects.

The Dry Roof Pro' flat roof leak detector provides a rapid method of testing a wide range of roofing membrane types and thicknesses of between 64µ and 25.6mm.

Kits contain everything required to start testing immediately (even batteries and charger), all contained in a robust, high-visibility transit case.

The Dry Roof Pro' utilises the non-conductive properties of roof membranes as an electrical insulator.

As the detector passes a defect in the membrane, the current required to complete an electrical circuit reduces due to the lower dielectric strength of the membrane. As an electrical circuit is created, current 'jumps' the gap to earth; triggering the detector unit's alarm.

**Buckleys' Dry Roof Pro' can test up to 2,000m<sup>2</sup> per day and can pinpoint the exact location of leaks and faults; even if they are invisible to the naked eye.**



## Features

- Test up to 2,000m<sup>2</sup> per day
- Identify leaks invisible to the naked eye
- Pinpoint the exact location of leaks and defects
- Works with a variety of membranes and roof build-ups
- Lightweight & portable
- Easy to use
- Built-in test voltage calculator
- Audible & visual alarms
- Clear LCD with backlight
- Membrane keypad operation
- Microprocessor controlled
- Automatic voltage selector
- Accurate sensitivity control
- Rechargeable batteries
- Displays electrode current
- Range of accessories & electrodes available
- Volume control for quiet environments
- One year back-to-base warranty

## Specifications

- Output voltage range: 2-40kV
- Maximum output current: <1mA (continuous)
- Polarity: positive
- DC sensitivity: Adjustable - 10µA to 450µA (pre-set to 350µA)
- Batteries: 4 x D-cell rechargeable batteries
- Meter accuracy - Volts: +/-1.0% +/-1 digit  
- Current: +/- 2.0%
- Current meter FSD: 450µA
- Test voltage formula: NACE SP-02-74
- Unit dimensions: 172mm x 85mm x 235mm
- Unit weight: 2.9Kg - Incl. carrying bag, interconnecting lead, batteries and ESD wristband
- Handle weight: 720g
- Maximum relative humidity: 80% non-condensing
- Altitude: Up to 2000m
- Temperature range: 0°C - +40°C



# Typical flat roof types

The Dry Roof Pro' kit can test a variety of flat roof types, provided an adequate earth can be achieved and the roof's uppermost covering does not have an electrically-conductive content.

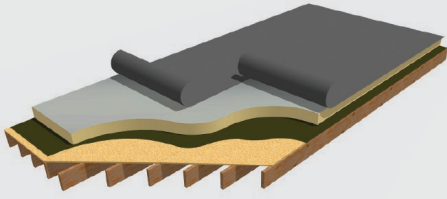

## Timber roof deck

Whilst the timber structure of the roof itself is non-conductive; foil-faced insulation and any water which has 'tracked' to earth through leaks will enable testing with the Dry Roof Pro'.

Many timber-deck roofs with foil-faced insulation have additional earth bonding which aids the leak detection process.

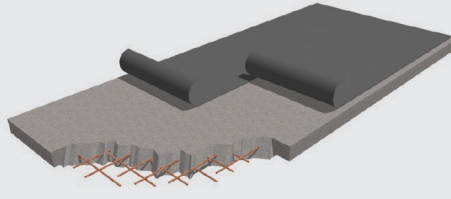

## Concrete roof deck

Concrete retains a surprisingly high water content. Even when concrete is 'dry', this ambient moisture content is enough to conduct current and test for leaks.

Flaws in the membrane allow the detector to complete an electrical circuit to earth via the concrete and trigger the detector's alarm.

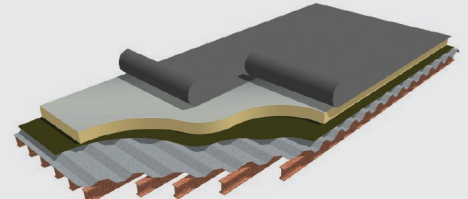

## Steel roof deck

The steel structure below the roof membrane – as well as foil-faced slab insulation – conducts electrical current to earth.

Faults in the membrane provide a path for current to pass through and complete an electrical circuit, triggering the detector's alarm.

# What's included?

**Buckleys Dry Roof Pro' flat roof leak detector kits contain everything required to test flat roofs for leaks; even batteries and a charger. The kit includes:**

- Dry Roof Pro' detector unit
- Coiled interconnecting lead
- Test probe handle
- 2 x 332mm mid-section extension rods
- 1 x 332mm end-section extension rod
- Knurled thumb-nut & back-nut
- 450mm phosphor-bronze brush electrode
- Stainless-steel drum-brush electrode
- Pointed probe electrode
- Battery charger and 4 x rechargeable batteries
- 5m earth lead on reel
- 50m earth extension lead
- Shoulder bag
- Test voltage calculator
- ESD Anti-static wristband
- Comprehensive instruction manual with calibration certificate
- High-visibility transit case



# Accessories



Battery Charger  
6005-0001



Knurled Thumb-Nut & Back-Nut  
6005-0465



High-Visibility Transit Case  
6005-0457



Rechargeable D-Cell Battery  
6005-0022



Insulated Extension Rod Mid-Section  
6005-0459



Insulated Extension Rod End-Section  
6005-0460



Drum Brush Electrode  
6005-0237



ESD Anti-static Wristband  
4016-0132



50m Earth Extension Lead  
6005-0076



Phosphor-Bronze Electrodes  
(See Data Sheet E1)



Coiled Interconnecting Lead  
6005-0451

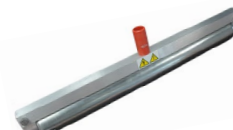

500mm Roller Electrode  
6005-0231



Yellow Wax Crayons  
6005-0050



Seam Probe Tool  
6005-0021



Dry Roof Pro' Carrying Bag  
6005-0456



Test Voltage Calculator  
6005-0083

## Wet Roof Pro'

**We also manufacture a roof leak detector for use in wet weather conditions.**

The Wet Roof Pro' uses the conductive properties of water (from either rainfall or a hose) to pinpoint leaks in a variety of non-conductive roof finishes.

The kit comprises two main components; a generator and a detector. The generator creates a field of electrical current on the roof surface and to earth via any leaks or defects. The detector unit uses two test probes to measure the direction of current flow and therefore location of the leak.

**Contact us for more information on Buckleys' range of roof leak detection equipment, call our sales team on +44 (0)1303 278888, email [sales@buckleys.co.uk](mailto:sales@buckleys.co.uk) or visit our website: [www.buckleysinternational.com](http://www.buckleysinternational.com)**



**BUCKLEYS**

Buckleys House, Unit G, Concept Court, Shearway Business Park, Shearway Road, Folkestone, Kent CT19 4RG, UK  
Tel: +44 (0)1303 278888 Fax: +44 (0)1303 274331 email: [sales@buckleys.co.uk](mailto:sales@buckleys.co.uk)



[www.buckleysinternational.com](http://www.buckleysinternational.com)