

PROTECT A1 ROOFING UNDERLAY

Protect A1 is a 'third-generation' roofing underlay which has been developed specifically to overcome the disadvantages of traditional Type 1F felts and second-generation plastic sheet materials.



Application

Protect A1 can be used for all pitched roof constructions (tiled and slated), whether the insulation is at ceiling joist level or at rafter level.

Advantages

- Completely waterproof.
- Can be used as a temporary covering for up to three months before the roof covering is laid.
- Excellent nail tear strength and tensile strength.
- 'Unrestricted' use for wind uplift in all exposure conditions in the UK and Ireland.
- UV and heat stable.
- Absorbent undersurface prevents condensate drip-off.
- Embossed dark grey upper surface reduces glare and takes a chalk line marking.
- Does not generate noise under wind gusting.
- Easy to cut, clean, light to handle and unaffected by temperature changes.
- Independently certified.

WIND UPLIFT

Type 1F reinforced bitumen has been the traditional underlay in this country for decades and can resist the worst wind uplift conditions expected in the UK. Many of the modern lightweight alternatives even those with independent certification have batten gauge restrictions when fixed in exposed locations. An independent report on wind load calculations shows that a resistance of at least 2.5kPa is required at maximum batten gauge to ensure that an underlay can be safely used at more than 95% of all locations in the UK. All Protect roofing underlays have a resistance of at least 2.5kPa giving them unrestricted use for wind uplift in all exposure conditions in the UK and Ireland.

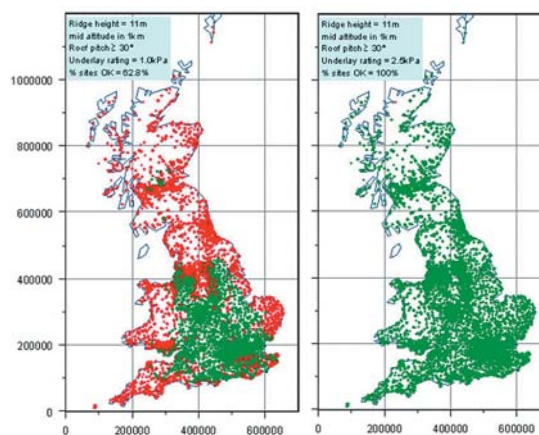

Ridge height 11.0m
Mid altitude
Roof pitch 30°
Underlay rating 1.0kPa

Ridge height 11.0m
Mid altitude
Roof pitch 30°
Underlay rating 2.5kPa

- restricted use
- unrestricted use (**Protect A1**)

PROTECT A1 ROOFING UNDERLAY



Composition, manufacture

Twin-ply construction of polypropylene non-woven spunbond layer and PP film.

Size

Roll sizes: 1.5m x 30m (45m²)
1.0m x 45m (45m²)

Roll weight: 7.5kg (including core)

Also available in 1m x 15m (15m² 3kg) ideal for smaller jobs and the jobbing builder.

Compatibility

As with most underlay materials, should not be laid in direct contact with any undried

timber preservatives. Proprietary underlay protector should be used at gutter detail.

Roof ventilation

Roof space ventilation should be provided at both low and high level as with all impermeable (type HR) roofing underlays irrespective of insulation type or position. Where insulation follows the rafters, there must be a ventilated air space at least 50mm deep above the insulation and beneath the underlay.

More information is available on request.

Specification clause

Roofing underlay to be Protect A1 supplied by Glidevale Limited, 2 Brooklands Road, Sale, Cheshire M33 3SS. Telephone: 0161 905 5700, Fax: 0161 905 2085. Underlay to be of twin-ply construction with polypropylene non-woven spunbond layer and LDPE/PP film. Under surface to have absorbent characteristics to prevent condensate drip off. To be laid in accordance with BS 5534: Part 1: 1997 and manufacturer's instructions.

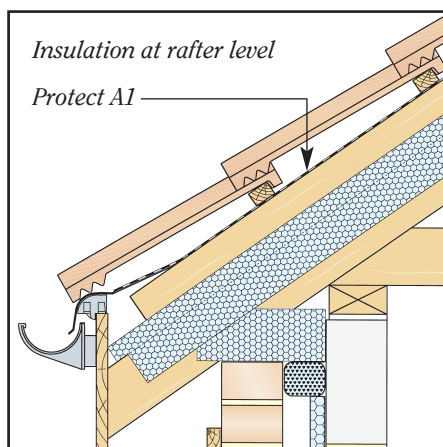
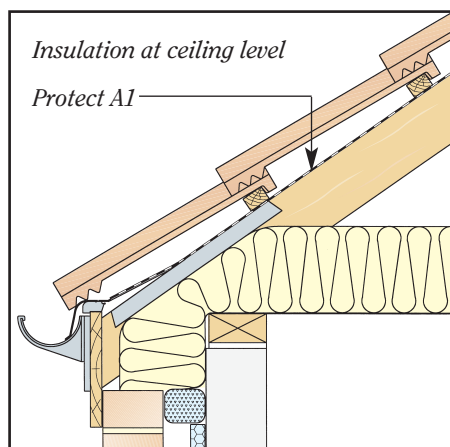

Performance	MD	CD
Nail tear strength (N) (EN12310-1 with mods)	230	234
Tensile strength (N/50mm) (EN12311-1 with mods)	287	274
UV and Heat stability (after 336 hours ageing and 90 days)		
Tensile strength (N/50mm) (EN12311-1 with mods)	285	238
Wind Uplift Resistance	2.5kPa at 343mm batten guage and 600mm rafter centres	
Watertightness	W1 Pass > 2.0m	
Weight (g/m²)	145	

MD = machine direction (along roll), CD = cross direction (across roll). Nail tear strength tested to EN12310-1 with mods. Tensile strength tested to EN12311-1 with mods. UV and heat ageing conditions: UVA lamps at 50°C. for 336 hours followed by heat ageing at 70°C for 90 days.

GLIDEVALE LIMITED

2 Brooklands Road, Sale, Cheshire M33 3SS Tel: 0161-905 5700 Fax: 0161-905 2085
Email: info@glidevale.com Web: www.glidevale.com

Glidevale Limited maintains a policy of continuous development and reserves the right to amend product specifications without notice.

BPD

A member of the Building Product Design Group

