



Klober's Secret Gutter is a high performance secret gutter for use with all flat interlocking tiles which provides a secondary line of defence against wind driven rain at wall abutments.

Product features & benefits

- Cost effective alternative to lead
- Lightweight and durable
- Quick and easy to install
- Anti-capillary rib provides extra watertightness

Area of application

Suitable for:

- Flat interlocking tiles

Material

Black UV stabilised PVC

Dimensions

3m x 97mm wide x 1.1mm

Product Code

KR972000

Packaging / Weight (per pack)

Banded in packs of 5 pcs / 10kg per 5 pcs

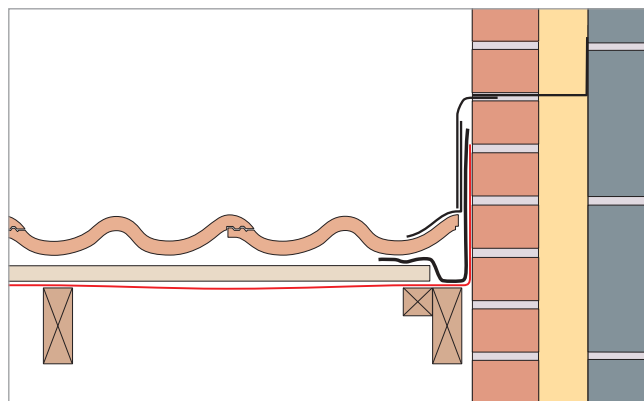
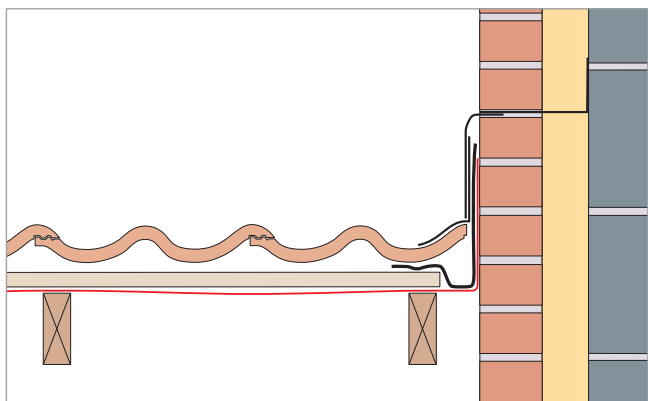

Installation

Lay underlay and allow for 50mm turn up at abutment wall. Finish tiling battens 55mm from wall and secure into rafter. Provide a tilting fillet at the eaves below the Secret Gutter to support a code 4 or 5 lead gutter outlet.

Starting from the eaves lay and fix the Secret Gutter using clout headed nails at approx 1m centres. The edge of the Secret Gutter will require 8mm drilled holes prior to fixing.

Lay the tiles as normal allowing a maximum gap of 15mm to the wall. It may be necessary to remove the end nib. A code 4 or 5 lead cover flashing is required at the ridge.

If the end rafter is less than 55mm from the abutment wall a 50 x 50mm support batten needs to be fixed to the end rafter. The tiling battens then need to finish 55mm from the abutment wall and fixed to this support batten.

TS-05#27-UK-0314. We assume no liability for typing errors.

Klober Ltd

Unit 6F · East Midlands Distribution Centre · Short Lane · Castle Donington · Derbyshire · DE74 2HA
Tel. +44 (0)1332 813 050 · Fax +44 (0)1332 814 033 · www.klober.co.uk · info@klober.co.uk

KLOBER