



Manthorpe Building Products Ltd
 Manthorpe House
 Brittain Drive
 Codnor Gate Business Park
 Ripley, Derbyshire DE5 3ND

Tel: **01773 514 200**
 Email: sales@manthorpe.co.uk
www.manthorpe.co.uk

Vent Roll



roll-out dry ridge system

Supplied in lengths of 6 metres, the Ridge Roll is placed along the length of the ridge prior to the ridge tiles being installed.

The roll is made up of a vapour permeable membrane down the centre, with a corrugated acrylic coated aluminium strip down each edge.

The malleability of the aluminium allows the roll to be shaped to the profile of the roof tiles and is secured in place with a butyl strip already attached to the underside.

The punched, vapour permeable membrane will provide ventilation to the roof void of 5,000mm²/m whilst avoiding the ingress of wind driven rain and the entry of large insects.

The Ridge Roll forms part of Manthorpe's Dry Ridge System which can be purchased as a kit, with all the parts required to cover a run of approximately 6 metres.

Product Specification Guide			
Reference	Description	Material	Box Quantity
GDRR-RR	6m Vent Roll	Acrylic Coated Aluminium	1
GDRR-BS	Batten Support Bracket	Galvanised Steel	10
GDRR-RU	Ridge Union	Polypropylene	12

Manthorpe Quality

Manthorpe manufactures a range of ventilation and building products at its headquarters in Derbyshire under an ISO9001 Quality Assurance Scheme.

All products are designed to comply with the relevant current Building Standards when fitted in accordance with the manufacturer's instructions. The company maintains a policy of continuous investment and development of its product range and reserves the right to amend the specifications without notice.



roll-out dry ridge system

The Manthorpe Roll-Out Dry Ridge is a mechanically fitted system which securely fixes the ridge tiles onto a roof, protecting them from wind uplift and rain penetration.

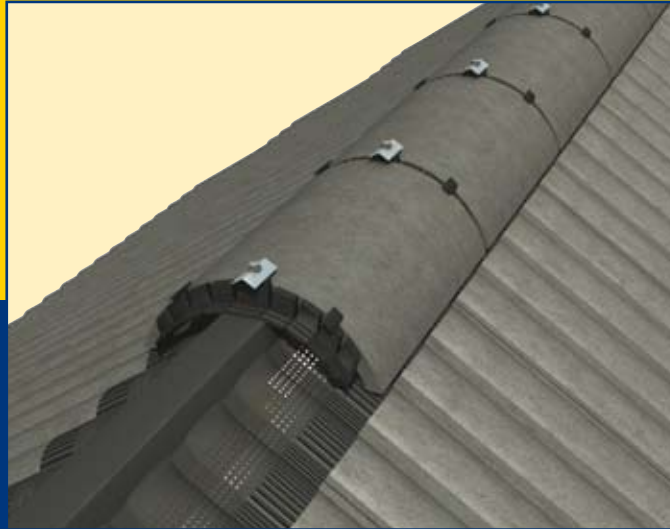

Ridge Union

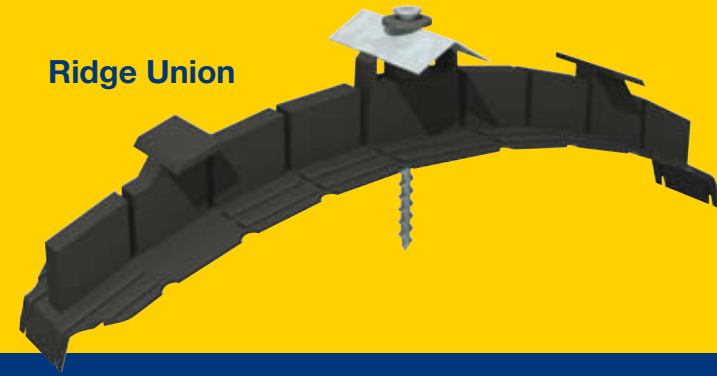

Support Bracket

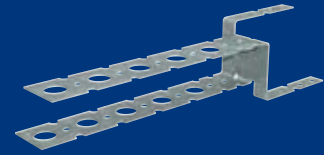
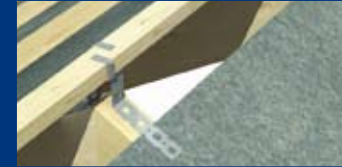

The system provides 5,000mm²/m ventilation to the roof void through the vent roll, the equivalent to a continuous 5mm gap.

Due to the nature in which the system is fitted, there is no need for mortar, making the job of fixing the ridge quick, easy and clean, as well as making it possible during frosts and other adverse weather conditions.

The system is compatible with most makes of concrete half-round and angled ridge tiles and most slate, flat concrete and profiled tiles. The system can be fitted to the ridge of any duo pitch roof which has a pitch between 15 and 45 degrees.

A single box of Manthorpe Dry Ridge provides all of the components required for a ridge run approximately 6 metres in length (excluding the ridge tiles).

The system is available in 3 different colours (Black, Dark Brown and Terracotta) and can be used in conjunction with Manthorpe's Ridge End Caps and both their Linear and Standard Smart Verge systems.

- Mechanical fixing system for the ridge of a roof securely fixes the ridge tiles, protecting the ridge from wind uplift and rain penetration without the need for mortar and pointing
- One box supplies enough components for a 6m ridge length
- Compatible with most makes of concrete half-round and angled ridge tiles
- Can be used on roofs with a pitch of between 15 and 45 degrees
- The system is compatible with most slate, concrete flat and profiled tiles
- Provides a 5,000mm²/m ventilation into the roof space
- Quick and easy to fix with no special tool requirements
- Available in 3 different colours
- No need for mortar, the system can be installed in all weathers
- Ridge ends can be finished off with Manthorpe's Ridge End Caps, available from their Smart Verge range
- UV stabilised.

The Ridge Union sits in the gaps between each of the ridge tiles, holding them in place. The Ridge Union Body slides onto the end of the ridge tile and is flexible so that it bends to the shape of the tile. The next ridge tile slots into the other side of the Ridge Union Body and this continues along the full length of the ridge.

Made from galvanised steel, manufactured to BS EN 1461:1999, the Manthorpe Batten Support Bracket provides a steady, secure platform for the horizontal ridge batten at the apex of the rafters.

The brackets have four different bend points and are designed to hold a single length of 25 x 38mm batten. One bracket should be placed at the apex of each rafter along the ridge.

The Manthorpe Roll-Out Dry Ridge System has been independently wind tunnel tested by the BRE. Testing complies with the requirements of BS 6399-2: 1997 Code of practice for wind loads.